



X-Maxx® WideMAXX® Suspension Kit

Covers Part #7895, 7895G, 7895R, 7895T, 7895X

Tip: Refer to the exploded views included with your truck to assist with installation of the X-Maxx WideMAXX Suspension Kit.

Suspension Tuning

1. Remove the two front and two rear shocks from the truck.
2. Remove the shock springs from all four shocks.
3. Replace the 30wt silicone shock oil in the front and rear shocks with 40wt silicone shock oil (part #5033, sold separately) for optimal suspension performance. Fill the shocks with 100% pure silicone shock oil to help prolong the life of the seals. When adding shock oil, be sure to allow any air bubbles to escape.
4. Install the included shock springs (1.346 rate, blue stripe) on all four shocks.
5. Reinstall the front and rear shocks on the truck.
6. Adjust the shock upper spring retainers until the front and rear driveshafts sit level. Adjust the spring retainers in pairs, equal amounts for both front shocks and both rear shocks.

If you have questions or need technical assistance, call Traxxas at

1-888-TRAXXAS

(1-888-872-9927) (U.S. residents only)

GTX Shock Assembly

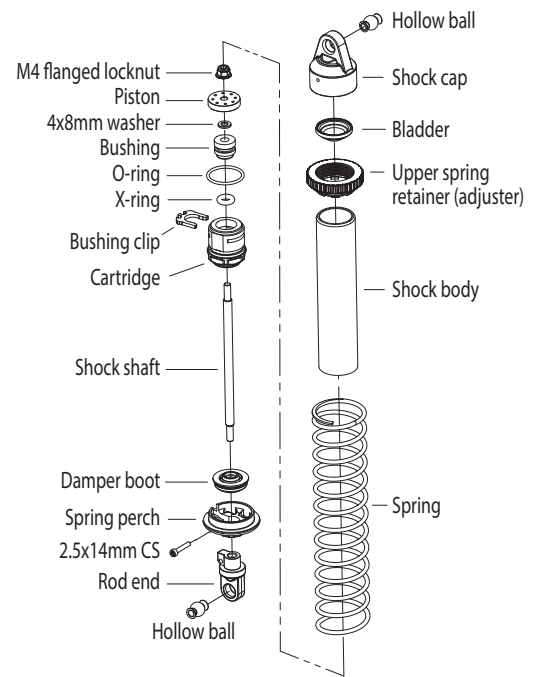

Replacement Parts

7856	Springs, shock (natural finish) (GTX) (1.346 rate, blue stripe) (2)	7894	Suspension arm, lower, black (1) (left, front or rear) (for use with #7895 X-Maxx® WideMaxx® suspension kit)
7892	Suspension arms, upper, black (left or right, front or rear) (2) (for use with #7895 X-Maxx® WideMaxx® suspension kit)	7894G	Suspension arm, lower, green (1) (left, front or rear) (for use with #7895G X-Maxx® WideMaxx® suspension kit)
7892G	Suspension arms, upper, green (left or right, front or rear) (2) (for use with #7895G X-Maxx® WideMaxx® suspension kit)	7894R	Suspension arm, lower, red (1) (left, front or rear) (for use with #7895R X-Maxx® WideMaxx® suspension kit)
7892R	Suspension arms, upper, red (left or right, front or rear) (2) (for use with #7895R X-Maxx® WideMaxx® suspension kit)	7894T	Suspension arm, lower, orange (1) (left, front or rear) (for use with #7895T X-Maxx® WideMaxx® suspension kit)
7892T	Suspension arms, upper, orange (left or right, front or rear) (2) (for use with #7895T X-Maxx® WideMaxx® suspension kit)	7894X	Suspension arm, lower, blue (1) (left, front or rear) (for use with #7895X X-Maxx® WideMaxx® suspension kit)
7892X	Suspension arms, upper, blue (left or right, front or rear) (2) (for use with #7895X X-Maxx® WideMaxx® suspension kit)	7896	Driveshaft, steel constant velocity (shaft only, 190.3mm) (1) (for use with #7895 X-Maxx® WideMaxx® suspension kit)
7893	Suspension arm, lower, black (1) (right, front or rear) (for use with #7895 X-Maxx® WideMaxx® suspension kit)	7897	Toe links, 202.5mm (187.5mm center to center) (black) (2) (for use with #7895 X-Maxx® WideMaxx® suspension kit)
7893G	Suspension arm, lower, green (1) (right, front or rear) (for use with #7895G X-Maxx® WideMaxx® suspension kit)	7897A	Toe links, front (TUBES black-anodized, 6061-T6 aluminum) (2) (for use with #7895 X-Maxx® WideMaxx® suspension kit)
7893R	Suspension arm, lower, red (1) (right, front or rear) (for use with #7895R X-Maxx® WideMaxx® suspension kit)	7897G	Toe links, front (TUBES green-anodized, 6061-T6 aluminum) (2) (for use with #7895G X-Maxx® WideMaxx® suspension kit)
7893T	Suspension arm, lower, orange (1) (right, front or rear) (for use with #7895T X-Maxx® WideMaxx® suspension kit)	7897R	Toe links, front (TUBES red-anodized, 6061-T6 aluminum) (2) (for use with #7895R X-Maxx® WideMaxx® suspension kit)
7893X	Suspension arm, lower, blue (1) (right, front or rear) (for use with #7895X X-Maxx® WideMaxx® suspension kit)	7897X	Toe links, front (TUBES blue-anodized, 6061-T6 aluminum) (2) (for use with #7895X X-Maxx® WideMaxx® suspension kit)